

Environmental Health PENDER COUNTY, North Carolina

P. O. Box 1209
Burgaw, NC 28425

Environmental Health
910-259-1233

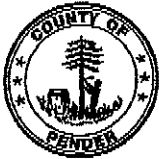

IMPROVEMENT PERMIT SITE

Page # 1

No Zoning or Building Permit is to be issued with this permit.

See Article 11 NC General Statutes, Chapter 130A-336 through 130A-338

<u>Zoning Determination</u>	<u>Construction Authorization</u>	Permit# : 074038	Fee : 250.00
GG	11/19/07	Issued Date : 01042008	Code Violation:
		Issued By : AB31	GEO PIN # : 32819634390000
		EH - File # : 102527	
		EHS ASSIGNED CC	

Permitted Use / Description of Work

single family residential

Description of Work

SFR 48x55

Applicant: APPLIED RESOURCE MANAGEMENT
 PO BOX 882
 HAMPSTEAD NC
Relationship of Applicant to Owner:
 AGENT

Work Phone: 270-2919
 Home Phone:
 Fax :

Owner : JACATASH LLC
 WASHINGTON ACRES RD 2110
 HAMPSTEAD NC

Work Phone:
 Home Phone:
 Fax :

SITE ADDRESS : 2110 HAMMOCK WATCH WAY LOT #4
 Subdivision :
 Section /Block : Lot: 4
 Township : TOPSAIL

Deed Book/Page:
 Plat Bk. & Page#:

WATER SUPPLY : Community Water SEWER SERVICE Private Septic

Directions to Site:

lot #4, hwy 17 south, left onto Washington Acres Rd, right onto Hammock Watch Way, just past Dogwood, lot on right

Requirements

- LOT SIZE - 20,000 SQ FT
- EXISTING WELLS, SPRINGS, OR EXISTING WATER LINES ON PROPERTY - N
- ANY JURISDICTIONAL WETLANDS - N
- IS THE SITE SUBJECT TO APPROVAL BY ANY OTHER PUBLIC AGENCY - N
- STRUCTURE/CONSTRUCTION TYPE - HOUSE
- NUMBER OF BEDROOMS - 4
- NUMBER OF OCCUPANTS - 8
- BASEMENT - N
- GRINDER PUMP FOR LOWER LEVEL PLUMBING - N
- SYSTEM TYPE - II-A
- LTAR (GPD/FT) - .8
- DAILY DESIGN FLOW (GPD) - 480
- WASTEWATER TYPE - DOMESTIC
- SEPTIC TANK SIZE (GALLONS) - 1,000
- NITRIFICATION FIELD (SQ. FT) - 600
- NUMBER OF LINES - 4
- LENGTH OF LINES (FT) - 50
- TRENCH WIDTH (INCHES) - 36
- TRENCH DEPTH (INCHES) - 18-24
- TYPE OF WATER SUPPLY - PUBLIC
- TYPE OF FACILITY THE PROPOSED SITE IS TO SERVE - 4 BR. DWELLING
- DISTANCE FROM ALL WELLS (FT) *NO CASE LESS THAN 50 FT. - 100

Environmental Health PENDER COUNTY, North Carolina

P. O. Box 1209
Burgaw, NC 28425

Environmental Health
910-259-1233



IMPROVEMENT PERMIT SITE

Page # 2

No Zoning or Building Permit is to be issued with this permit.

See Article 11 NC General Statutes, Chapter 130A-336 through 130A-338

<u>Zoning Determination</u>	<u>Construction Authorization</u>	Permit# : 074038	Fee : 250.00
GG	11/19/07	Issued Date : 01/04/2008	Code Violation:
		Issued By : AB31	GEO PIN # : 32819634390000
		EH - File # : 102527	
		EHS ASSIGNED CC	

No Zoning or Building Permit is to be issued with this permit.
See Article 11 NC General Statutes, Chapter 130A-336 through 130A-338
This permit is subject to revocation if site plans or intended use changes.

This permit does not constitute a warranty or guarantee and satisfactory performance is not assured by the Pender County Health Department.

The site is subject to approval by other public agencies 1973 (b) (1) (c).

Conditions

Prior to CA issuance: Submit a finalized survey map that includes drainage plan to the Pender County Health Dept.

Notes

Before final zoning, proof of water provider must be submitted

Improvement Permit: Clay Crevel

Issue Date: 01-19-08

5 Year Improvement Permit: _____

Issue Date: _____

Improvement Permit, No Expiration Date: _____

Issue Date: _____

System Design: FA

Bedrooms

4

GPD

480

LITAR

.8

Square Ft.

600

Linear Ft.

200

Lines @ 50 feet

Trench Depth

18" ^{18"}

Trench Width w/ Lines 9' on center.

1. HAMP COUNTY HEALTH DEPT.
 ENVIRONMENTAL HEALTH SECTION
 P.O. BOX 1209
 BURGAW, NC 28425

PERMIT # 102527
 PAGE 3 OF 3
 SIGNATURE Ch. Campbell DATE 01-18-08

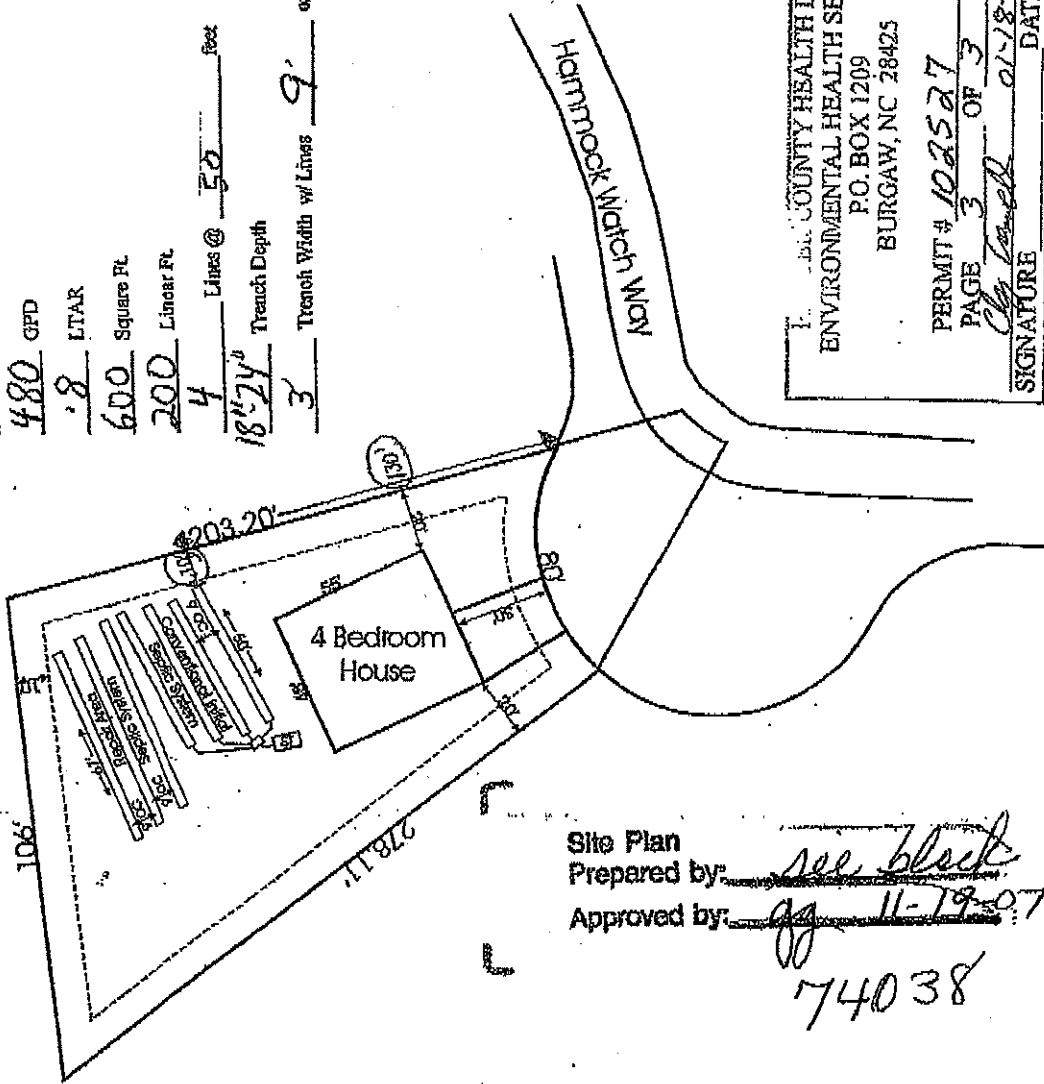

Site Plan
 Prepared by: see block
 Approved by: gg 11-19-07
74038

LOT # 4

NOTES

1. Any basement excavation shall require a 15 foot setback and if a foundation drain is installed, the setback shall be increased to 25 feet.
2. A pump shall be installed if gravity flow cannot be maintained.

Handwritten signature and date: 11/15/07

Note: Adapted from surveys prepared by Talbot Land Surveying and Tripp Engineering, PC.

<p>Applied Resource Management PC P.O. Box 882, Hampstead, NC 28443 (910) 270-2919 FAX 270-2988</p>	TITLE: Proposed Septic And House Site Location-Drawing-Hammock-Watch-Lot-4		FIGURE: 1	
	JOB: 0420	SCALE: 1" = 60'	DATE: 11/2/07	DRAWN BY: EFC

*IF GRAVITY FLOW CANNOT BE MAINTAINED, A PUMP SYSTEM WILL BE REQUIRED.